



RIG 52 - TELESCOPIC DOUBLE

Depth Capacity (TVD) : 4,500m Rig Loads : 27 (+ Rentals & Pipe)

MAST

Mast Type	<i>Telescopic Double</i>	Drill Line Size (mm)	28.6
Mast MFG	<i>Ja-Co</i>	Number of Lines	10
Static Hook Load (daN)	196,000	3:1 Capacity (daN)	191,000
Mast Clear Height (m)	32.3	2:1 Capacity (daN)	287,000

Drill Line is 9x40 Constructex wire rope.

3 : 1 Safety factor drilling; 2 : 1 Safety factor running, casing or stuck pipe.

SUBSTRUCTURE

Substructure Type	<i>One Piece, Step-down</i>	Racking Capacity (101.6 mm)	5,900 m
Substructure MFG	<i>Ja-Co</i>	Racking Capacity (114.3 mm)	5,900 m (w/DS40 TJ)
Setback Capacity (daN)	178,000	Racking Capacity (127.0 mm)	3,900 m
BOP-Sub Clr. w/ Pony (m)	4.43	Racking Capacity (139.7 mm)	2,800 m
Floor Height w/ Pony (m)	5.49	Rotary Table MFG	<i>BOMCO</i>
Pony Sub Height (m)	1.22	Rotary Table Capacity (daN)	178,000
		Rotary Table Size	27.5"

Racking Capacity does NOT take into account the added weights of HWDP or drill collars.

DRAWWORKS (MECHANICAL)

Drawworks MFG	<i>Revolution Equipment</i>	Drawworks Drive	<i>CAT C-27</i>
Drawworks Model	<i>REM-850</i>	Drive Rating (hp)	875
Single Line Pull (daN)	24,500	Auxiliary Brake	<i>Eaton 236WCBD</i>
Rated Power (hp)	850	Transmission	<i>Allison 6620</i>

OVERHEAD EQUIPMENT

Block Model	<i>American Block 250T</i>	Block Capacity (ton)	250
Hook Model	<i>Ja-Co 250T</i>	Becket Capacity (ton)	250
Topdrive	<i>Canrig 6027AC</i>	Make-Up Torque (ft-lb)	54,000 w/ Torque Boost
Continuous Torque (ft-lb)	30,000	Break-Out Torque (ft-lb)	60,000 w/ Torque Boost

HIGH PRESSURE CIRCULATING SYSTEM

System Pressure (psi)	7,500
-----------------------	-------

MUD PUMPS (DUAL FUEL)

Pump MFG & Model (qty)	<i>TSC Offshore WF-1300 (2)</i>	Mud Pump Drive (qty)	<i>Cummins QST30 (2)</i>
Pump Rated Power (hp)	1,300 (Each)	Pump Drive Rating (hp)	1,350 (Each)
Pump Stroke Length	11"	Gear Box Ratio	2 : 1 & 3 : 1
Gear Box MFG	<i>Rouse Industries</i>	Gear Box Rated Power (hp)	1,350 (Each)

MUD SYSTEM WITH HYDRAULIC ROOF

Total Volume (m ³)	161	# of Mud Tanks	2
Active Volume (m ³)	129	# of Compartments	6 + 1 Trip + 1 Pill
Trip Tank Volume (m ³)	4.5	Pill Tank Volume (m ³)	8.5
Agitators Power (qty)	5.6 kW (5) + 4.1 kW (1)	Mixing Hopper (qty)	Conventional (2)
Centrifugal Pump Quantity	4	Centrifugal Pump Size (mm)	152 x 127 x 356
Shale Shaker	<i>Brandt King Cobra Dual</i>	Degasser Size (mm)	914



BOPs (NACE)

Annular	<i>HRSB Spherical</i>	Pressure Rating & Size	<i>2,000 psi, 21-1/4"</i>
Ram #1	<i>HRSB - Single</i>	Pressure Rating & Size	<i>2,000 psi, 21-1/4"</i>
Ram #2	<i>HRSB - Single</i>	Pressure Rating & Size	<i>2,000 psi, 21-1/4"</i>

ACCUMULATOR

Accumulator MFG	<i>Control Technology</i>	Operating Pressure (psi)	<i>3,000</i>
Accumulator Volume (l)	<i>742</i>	# of Stations	<i>6</i>

CHOKE MANIFOLD (NACE)

Type	<i>Double Gut</i>	Pressure Rating (psi)	<i>5,000</i>
Size	<i>3-1/8"</i>		

GENERATOR SETS (DUAL FUEL)

Generator MFG	<i>Stamford</i>	Engine MFG	<i>Cummins</i>
Generator Model (qty)	<i>HCI534E1 (4)</i>	Engine Model (qty)	<i>QSX15-G9 (4)</i>
Prime Rating (kW)	<i>507 (Each)</i>	Voltage (V)	<i>208 / 600</i>

MISCELLANEOUS EQUIPMENT

Fuel Tank Capacity (m ³)	<i>50 (Total)</i>	Catwalk	<i>Hydraulic</i>
# of Fuel Tanks	<i>1</i>	Catwalk Clear Height	<i>36"</i>
Water Tank Capacity (m ³)	<i>82 (Total)</i>	Catwalk Clear Width	<i>34"</i>
# of Water Tanks	<i>1</i>	Floor Wrench Type	<i>Canrig TM-80</i>
Pipe Tub Type	<i>Conventional</i>	Make-up Torque (ft-lb)	<i>60,000</i>
Pull-Down Capacity (daN)	<i>22,200</i>	Break-out Torque (ft-lb)	<i>80,000</i>

RENTAL

Boiler MFG (qty)	<i>York Shipley-Dual Fuel</i>	Boiler Rating (hp)	<i>125</i>
Flare Tank Skid	<i>As Required</i>	Loader	<i>As Required</i>

Rental equipment are not included in the rig load count.

Standard specifications represent the typical rig configuration, but could be subject to slight modifications from time to time due to customer requirements.

RIG 52 – TELESCOPIC DOUBLE PAD

Depth Capacity (TVD): 4,500m/14,800'
 (PAD MODE)

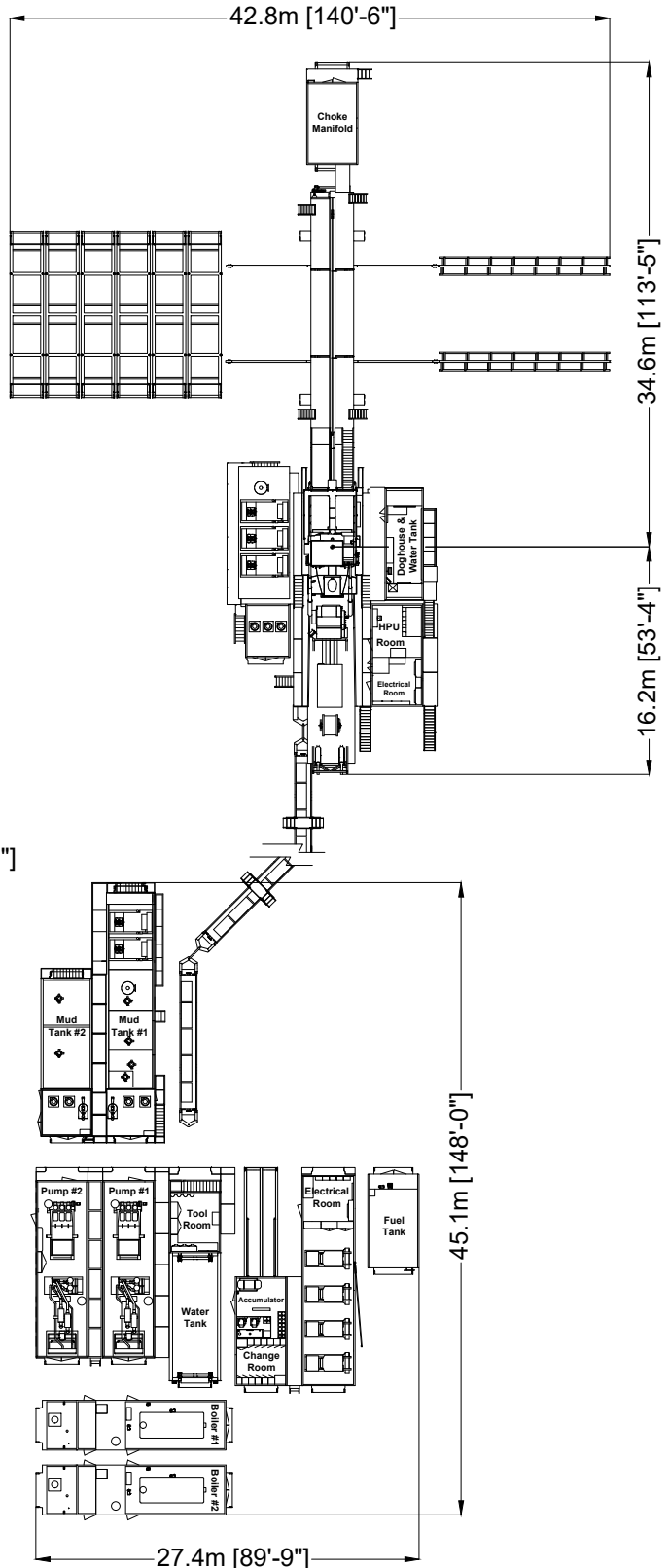
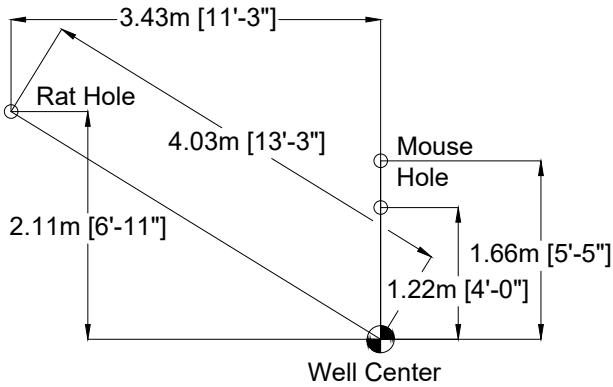

Quantity of pipe tubs and suitcases in the layout may vary due to customer requirements.

RIG 52 – TELESCOPIC DOUBLE PAD

Depth Capacity (TVD): 4,500 m / 14,800'

(CONVENTIONAL MODE)

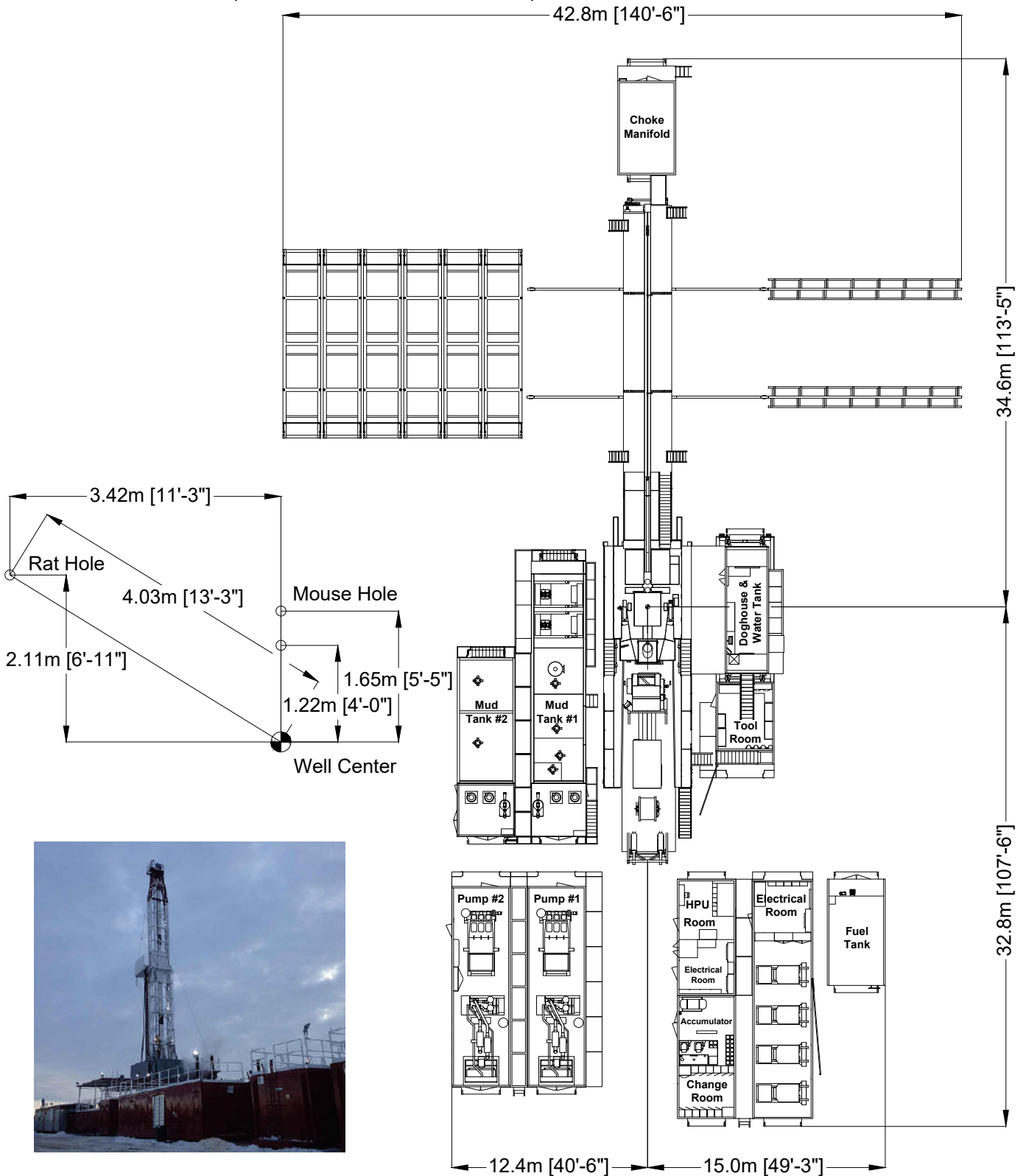

Quantity of pipe tubs in the layout may vary due to customer requirements.

RIG 52 – TELESCOPIC DOUBLE PAD

Depth Capacity (TVD): 4,500 m / 14,800'

Pad Mode:

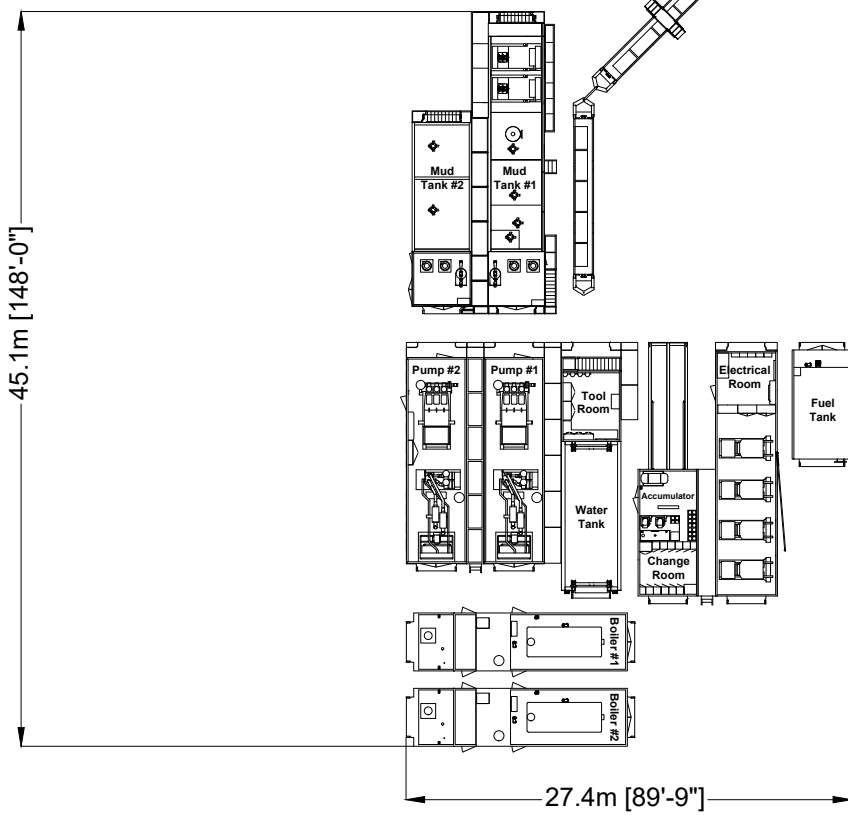
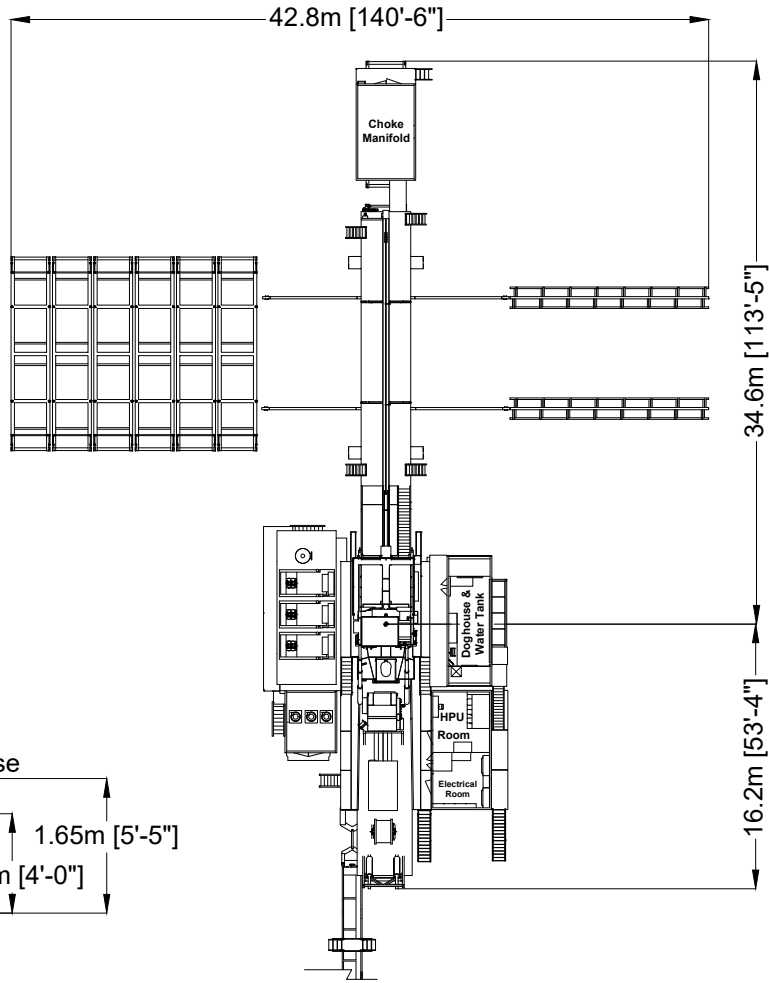
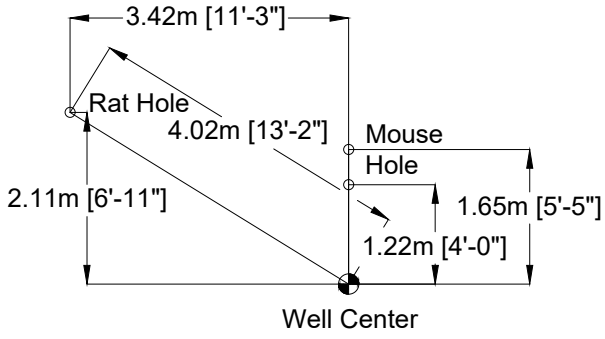

Conventional Mode:

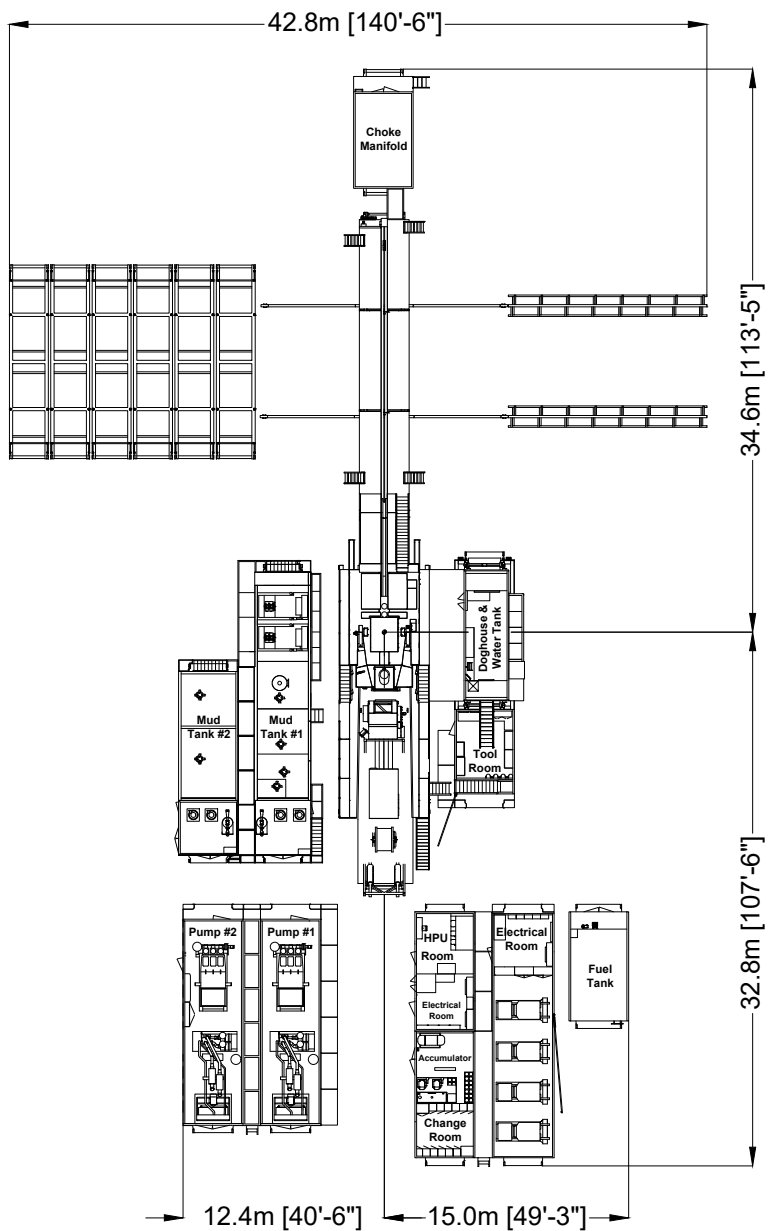

Quantity of pipe tubs and suitcases in the layout may vary due to customer requirements.