

RIG 55 - AC TELESCOPIC TRIPLE PAD

Depth Capacity (TVD) : 6,000 m Rig Loads : 48 (+ Rentals & Pipe)

MAST

Mast Type	<i>Telescopic Triple</i>	Drill Line Size (mm)	31.75
Mast MFG	<i>Ja-Co</i>	Number of Lines	10
Static Hook Load (daN)	267,000	3:1 Capacity (daN)	234,700
Mast Clear Height (m)	41.5	2:1 Capacity (daN)	352,000

Drill Line is 9x40 Constructex wire rope.

3 : 1 Safety factor drilling; 2 : 1 Safety factor running, casing or stuck pipe.

SUBSTRUCTURE & MOVING SYSTEM

Substructure Type	<i>One Piece, Step-down</i>	Racking Capacity (101.6 mm)	8,050
Substructure MFG	<i>Ja-Co</i>	Racking Capacity (114.3 mm)	8,050 (w/DS40 TJ)
Setback Capacity (daN)	245,000	Racking Capacity (127.0 mm)	6,450
Clear Height w/ Pony (m)	5.33	Rotary Table MFG	<i>BOMCO</i>
Floor Height w/ Pony (m)	6.55	Rotary Table Capacity (daN)	267,000
Pony Sub Height (m)	1.83	Rotary Table Size	27.5"
Moving System Type	<i>X-Y Stomper</i>	X Stroke (m)	1.02
Moving System MFG	<i>OCE PadMaster</i>	Y Stroke (m)	1.02

Racking Capacity does NOT take into account the added weights of HWDP or drill collars.

DRAWWORKS (AC)

Drawworks MFG	<i>American Block</i>	Drawworks Drive	<i>Ward Leonard AC Motor</i>
Drawworks Model	<i>DKS-1500B</i>	Drive Rating (hp)	1,600
Single Line Pull (daN)	34,770		

OVERHEAD EQUIPMENT

Block Model	<i>McKissick 350T</i>	Block Capacity (ton)	350
Becket Model	<i>Oil Country 350T</i>	Becket Capacity (ton)	350
Topdrive	<i>Tesco 350-EXI-600</i>	Make-Up Torque (ft-lb)	45,000
Continuous Torque (ft-lb)	30,000	Break-Out Torque (ft-lb)	45,000

HIGH PRESSURE CIRCULATING SYSTEM

System Pressure (psi)	7,500
-----------------------	-------

MUD PUMPS (AC)

Pump MFG & Model (qty)	<i>TSC Offshore WF-1600 (2)</i>	Mud Pump Drive (qty)	<i>Ward Leonard AC (2 per)</i>
Pump Rated Power (hp)	1,600 (Each)	Pump Drive Rating (hp)	1,150 (Each)
Pump Stroke Length	11"		

MUD SYSTEM WITH HYDRAULIC ROOF

Total Volume (m ³)	184	# of Mud Tanks	2
Active Volume (m ³)	155	# of Compartments	6 + 1 Trip + 1 Pill
Trip Tank Volume (m ³)	10.2	Pill Tank Volume (m ³)	8.2
Agitators Power (qty)	5.6 kW (5) + 4.1 kW (1)	Mixing Hopper (qty)	Conventional (2)
Centrifugal Pump Quantity	4	Centrifugal Pump Size (mm)	152 x 127 x 356
Shale Shaker	<i>Mongoose Pro Triple</i>	Remote Degasser (mm-qty)	914 (2)
Remote Degasser Tank	17.8 m ³		

BOPs (NACE)

Annular	<i>Shaffer - Spherical</i>	AER Dir 36 Class V & BC OGC Class C compliant	
Ram #1	<i>Shaffer - Double</i>	Pressure Rating & Size	<i>5,000 psi, 13-5/8"</i>
Ram #2	<i>Shaffer - Single</i>	Pressure Rating & Size	<i>5,000 psi, 13-5/8"</i>

* Hydraulic BOP handling system capacity is 35,600 daN.

ACCUMULATOR

Accumulator MFG	<i>Control Technology</i>	Operating Pressure (psi)	<i>3,000</i>
Accumulator Volume (l)	<i>848</i>	# of Stations	<i>6</i>

** Sized for a 346mm, 69,000 kPa stack with shear rams

CHOKE MANIFOLD (NACE)

Type	<i>Double Gut</i>	Pressure Rating (psi)	<i>5,000</i>
Size	<i>3-1/8"</i>		

GENERATOR SETS

Generator MFG	<i>Stamford</i>	Engine MFG	<i>Cummins</i>
Generator Model (qty)	<i>HCI534E1 (8)</i>	Engine Model (qty)	<i>QSX15-G9 (8)</i>
Prime Rating (kW)	<i>507 (Each)</i>	Voltage	<i>208 / 480 / 600</i>

MISCELLANEOUS EQUIPMENT

Fuel Tank Capacity (m ³)	<i>50 (Total)</i>	Pipe Tub Type	<i>Conventional</i>
# of Fuel Tanks	<i>1</i>	Pull-Down Capacity (daN)	<i>22,200</i>
Water Tank Capacity (m ³)	<i>80 (Total)</i>	Floor Wrench Type	<i>Canrig TM-120</i>
# of Water Tanks	<i>1</i>	Make-up Torque (ft-lb)	<i>90,000</i>
Catwalk	<i>Canrig Hydraulic***</i>	Break-out Torque (ft-lb)	<i>120,000</i>

*** Catwalk comes with four walking stompers. And cycle time is 50 sec.

RENTAL

Rental equipment are not included in the rig load count.

Boiler MFG (qty)	<i>York Shipley-Dual Fuel (2)</i>	Boiler Rating (hp)	<i>125 (Each)</i>
Flare Tank Skid	<i>As Required</i>	Loader	<i>As Required</i>

AC FEATURES

Climate Controlled Doghouse	ABB Drives
Driller's Console	Generator Synchronization
Touch Screens	LED Lighting
Drawworks & Mud Pump PLCs	8 Camera CCTV

PAD CONFIGURATION

Scalper Tank With Hydraulic Roof

Total Volume (m ³)	<i>63.4</i>	Shale Shaker MFG	<i>Mi-Swaco</i>
Active Volume (m ³)	<i>50.1</i>	Shale Shaker Model	<i>Mongoose Pro Triple</i>
Trip Tank Volume (m ³)	<i>7.9</i>	Centrifugal Pump Quantity	<i>3</i>
Festoon (m)	<i>100</i>	Centrifugal Pump Size (mm)	<i>152 x 127 x 356</i>
Umbilical System	<i>70 m (5x12.5m Each & 1x9.1m)</i>	Drilling Center+Complex Mats	<i>Included</i>

Standard specifications represent the typical rig configuration, but could be subject to slight modifications from time to time due to customer requirements.

RIG 55 – AC TELESCOPIC TRIPLE PAD

Depth Capacity (TVD): 6,000 m / 19,600'
(CONVENTIONAL MODE)

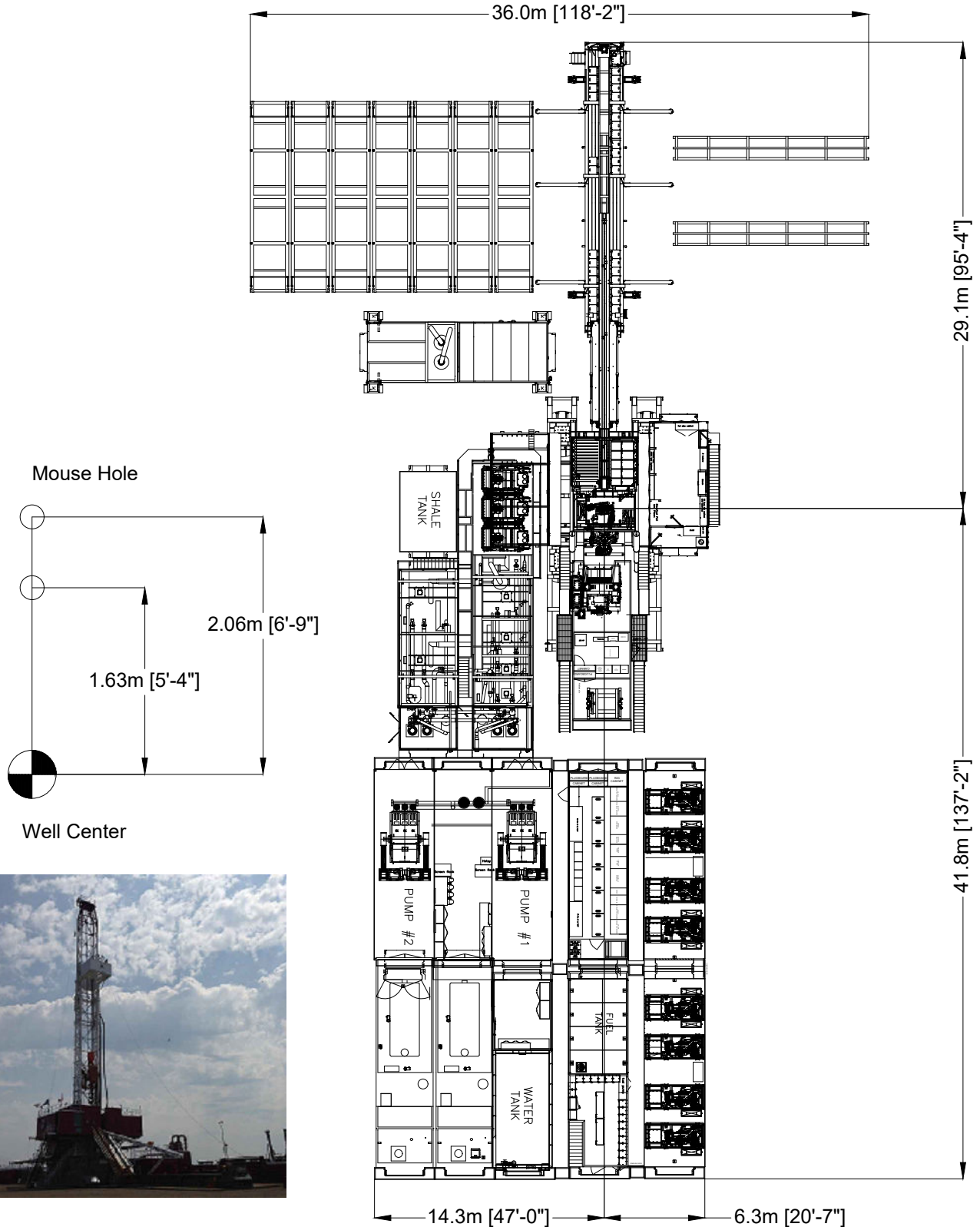

Quantity of pipe tubs in the layout may vary due to customer requirements.

RIG 55 – AC TELESCOPIC TRIPLE PAD

Depth Capacity (TVD): 6,000 m / 19,600'
(PAD MODE)

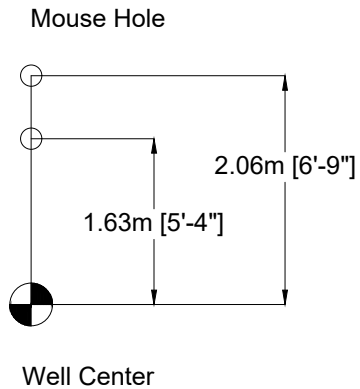
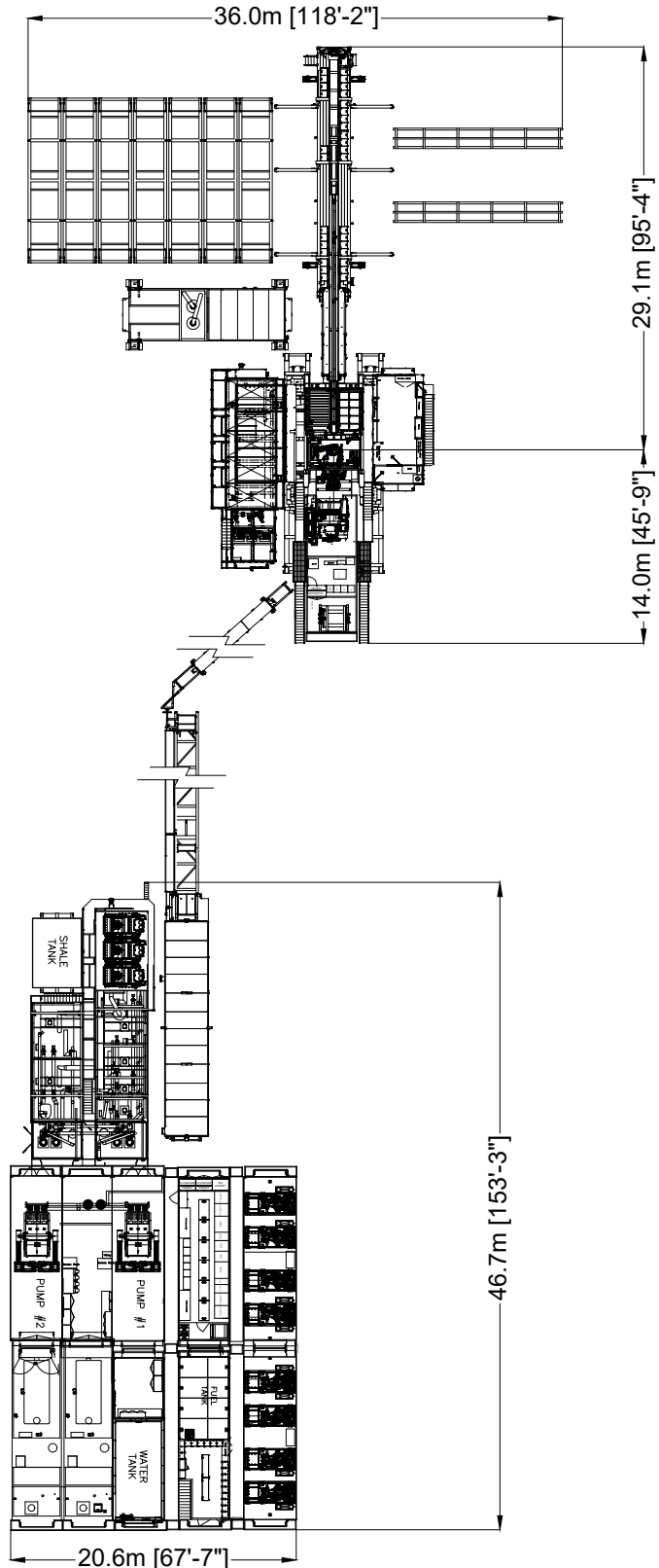

Quantity of pipe tubs in the layout may vary due to customer requirements.

RIG 55 – AC TELESCOPIC TRIPLE PAD

Depth Capacity (TVD): 6,000 m / 19,600'

Pad Mode:

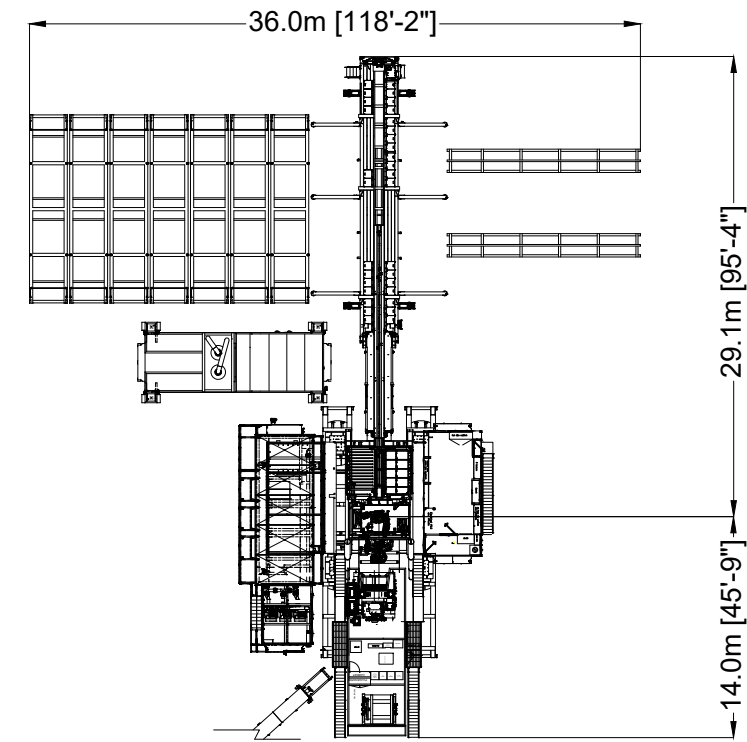

Mouse Hole

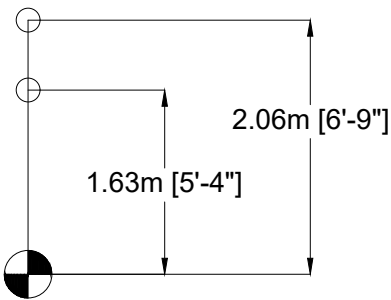

Well Center

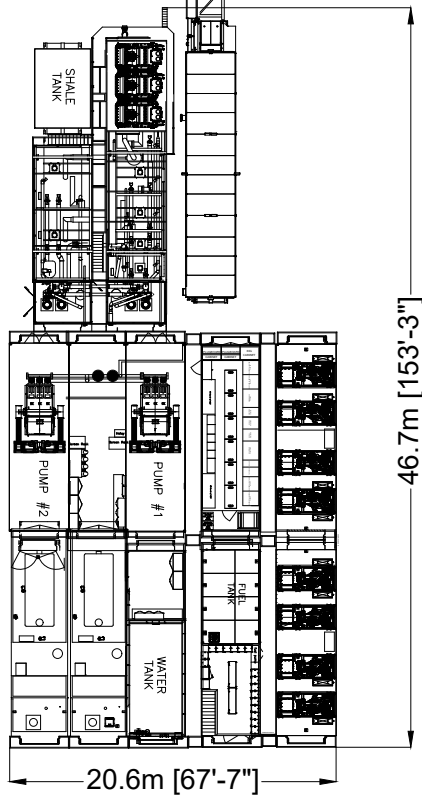

Conventional Mode:

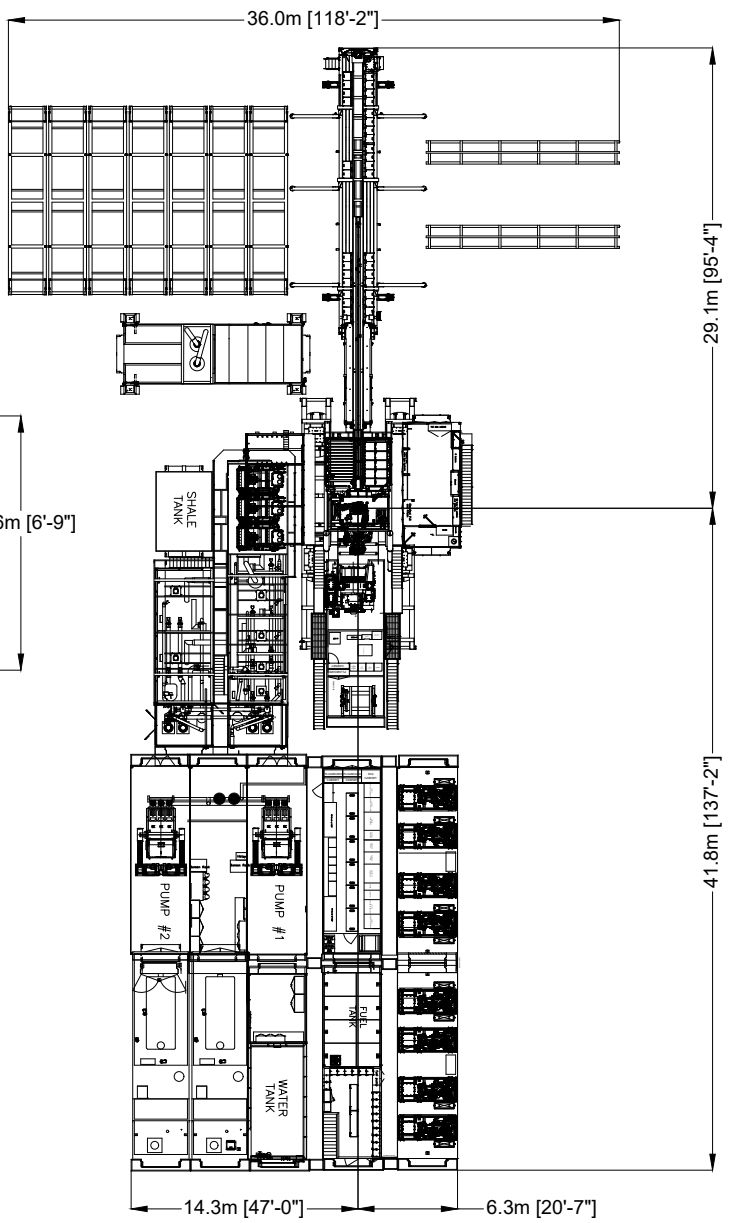

Mouse Hole

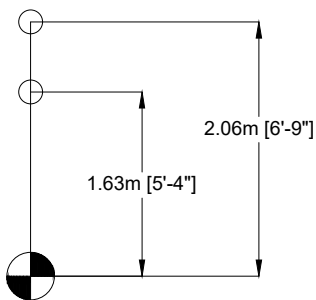

Well Center



Quantity of pipe tubs and suitcases in the layout may vary due to customer requirements.